



Admissions Student Resources Academics About NWFSC

Navigate to
NWFSC.EDU and click
on RaiderNet.

Apply Now

Learn More

FUTURES

BEGIN HERE

NORTHWEST FLORIDA STATE COLLEGE

Fast track your future! Registration - Open Enrollment for Spring 2022 begins November 15th. Visit [Raider Central](#) for more information!

Chat With Us



Secure Access Login

User Name:

Password:

[Forgot Password ?](#)

LOGIN

CLEAR

Welcome to NWF State College RaiderNet.

This secure site provides students, faculty, staff, and other college affiliates with single sign-on access to multiple sources of campus information and services. Enjoy!

College E-Mail Direct Login

**Log in using your
username and
password.**



E-MAIL



DEGREEWORKS



BLACKBOARD -
Online
Classrooms



ZOGHBY
LEARNING
COMMONS



CALENDAR



BOOKSTORE



IT SUPPORT



POLICE

 Student Profile

STUDENT PROFILE

Admissions, Financial Aid,
Registration, and Other
Student Resources

Once
logged in,
click on
Student
Profile.

FALL: Student Non-Payment Drop Schedule

Students who have not paid their ENTIRE account balance will be dropped from ALL classes, regardless of prior or partial payments.

NELNET: Students who have an active NelNet payment plan will NOT be dropped for nonpayment.

FALL TUITION IS DUE ON THE FOLLOWING DATES:

All Times Are At 6 AM on the Date Specified Unless Otherwise Noted.

Drop Dates	Registration Dates
August 12, 2021:	For Registration Before August 12, 2021
August 26, 2021:	Between August 18 and August 23
October 12, 2021:	Session 3
September 14, 2021:	Session 4

**Bio Information**

Email:
Phone:
Gender:
Date of Birth:
Ethnicity:
Race:

Citizen:
Citizenship:
Emergency Contact:
Emergency Phone:

General Information

Level:
Class:
Status:
Student type:
Campus:
First Term Attended:
Matriculated Term:
Last Term Attended:

Graduation Information
Graduation Applications:**CURRICULUM, HOURS & GPA****Primary**

Secondary

Hours & GPA

Degree: Associate in Arts
Level: Undergraduate
Program: AA in General Education
Major: General Education
Department: Priority Registration Eligible
Concentration: Not Provided
Admit Type: Standard
Admit Term: Fall Semester 2021
Catalog Term: Fall Semester 2021

REGISTERED COURSES

Course Title	Details	CRN	Hours	Registration Status
American History II	AMH 2020 ...	20007	3	Registered via Web
Earth Science	ESC 1000 006	20164	0	Class was Cancelled
Oceanography	OCE 1001C...	20172	4	Registered via Web
English Composition II	ENC 1102 L10	20507	3	Registered via Web
Developmental Mathematics II	MAT 0028 002	20842	4	Registered via Web

Total Hours | Registered Hours: 14 | Billing Hours: 14 | CEU Hours: 0 | Min Hours: 0 | Max Hours: 16

Click term
dropdown
menu and
select
appropriate
term.

Curriculum and Courses

Test Scores

Additional Links

Academic Calendar

Admissions

Degree Works

Registration and Planning

My Financial Aid

Student Billing

Student Forms

Enrollment Verification

View Grades



Curriculum and Courses

Test Scores

Additional Links

Academic Calendar

Admissions

Degree Works

Registration and Planning

My Financial Aid

Student Billing

Student Forms

Enrollment Verification

View Grades

Bio Information

Email:
Phone:
Gender:
Date of Birth:
Ethnicity:
Race:

Citizen:
Citizenship:
Emergency Contact:
Emergency Phone:

General Information

Level:
Class:
Status:
Student Type:
Campus:
First Term Attended:
Matriculated Term:
Last Term Attended:

Graduation Information

Graduation Applications:

CURRICULUM, HOURS & GPA

Primary

Secondary

Hours & GPA

Degree: Associate in Arts
Level: Undergraduate
Program: AA in General Education
Major: General Education
Department: Priority Registration Eligible
Concentration: Not Provided
Admit Type: Standard
Admit Term: Fall Semester 2021
Catalog Term: Fall Semester 2021

REGISTERED COURSES

Course Title	Details	CRN	Hours	Registration Status
American History II	AMH 2020 ...	20007	3	Registered via Web
Earth Science	ESC 1000 006	20164	0	Class was Cancelled
Oceanography	OCE 1001C...	20172	4	Registered via Web
English Composition II	ENC 1102 L10	20507	3	Registered via Web
Developmental Mathematics II	MAT 0028 002	20842	4	Registered via Web

Total Hours | Registered Hours: 14 | Billing Hours: 14 | CEU Hours: 0 | Min Hours: 0 | Max Hours: 16

Click on
Registration
and
Planning to
continue.

Registration

What would you like to do?



[Prepare for Registration](#)

View registration status, update student term data, and complete pre-registration requirements.



[View Registration Information](#)

View your past schedules and your ungraded classes.



[Browse Course Catalog](#)

Look up basic course information like subject, course and description.



[Register for Classes](#)

Search and register for your classes. You can also view and manage your schedule.



[Browse Classes](#)

Looking for classes? In this section you can browse classes you find interesting.

**Click
Register for
Classes to
view your
schedule.**

Select a Term

Terms Open for Registration

Select a term...

Non-Credit Fall 2021-Sum 2022 18-AUG-2021 - 17-AUG-2022

Spring Semester 2022 10-JAN-2022 - 05-MAY-2022

**Select the
appropriate
term.**

Register for Classes

Click on
Schedule and
Options.

Find Classes Enter CRNs **Schedule and Options**

Summary

Term: Spring Semester 2022

Title	Details	Hours	CRN	Schedule Type	Grade Mode	Level	Study Path	Date	Status	Message
American History II	AMH 2020, H04	3	20007	Lecture	Standard Letter	Undergraduate	None	11/09/2021	Registered	Registered vi...
Developmental Mathematics II	MAT 0028, 002	4	20842	Lecture	Prep Classes	Undergraduate	None	01/13/2022	Registered	Registered vi...
Earth Science	ESC 1000, 006	0	20164	Lecture	Standard Letter	Undergraduate	None	01/06/2022	Dropped	Class was Ca...
English Composition II	ENC 1102, L10	3	20507	Lecture	Standard Letter	Undergraduate	None	01/14/2022	Registered	Registered vi...
Oceanography	OCE 1001C, 001	4	20172	Lecture	Standard Letter	Undergraduate	None	01/11/2022	Registered	Registered vi...

Records: 5

Total Hours: 14 | Registered: 14 | Billing: 14 | CEU: 0 | Min: 0 | Max: 16

Schedule

Schedule Details

Class Schedule for Spring Semester 2022

	Sunday	Monday	Tuesday	Wednesday	Thursday	Friday	Saturday
6am							
7am							
8am							
9am							
10am							

Panels

Submit

Register for Classes

Click on the Printer
Icon to bring up the
Print Page.



Find Classes Enter CRNs **Schedule and Options**

Summary

Term: Spring Semester 2022

Title	Details	Hours	CRN	Schedule Type	Grade Mode	Level	Study Path	Date	Status	Message
American History II	AMH 2020, H04	3	20007	Lecture	Standard Letter	Undergraduate	None	11/09/2021	Registered	Registered vi...
Developmental Mathematics II	MAT 0028, 002	4	20842	Lecture	Prep Classes	Undergraduate	None	01/13/2022	Registered	Registered vi...
Earth Science	ESC 1000, 006	0	20164	Lecture	Standard Letter	Undergraduate	None	01/06/2022	Dropped	Class was Ca...
English Composition II	ENC 1102, L10	3	20507	Lecture	Standard Letter	Undergraduate	None	01/14/2022	Registered	Registered vi...
Oceanography	OCE 1001C, 001	4	20172	Lecture	Standard Letter	Undergraduate	None	01/11/2022	Registered	Registered vi...

Records: 5

Total Hours: 14 | Registered: 14 | Billing: 14 | CEU: 0 | Min: 0 | Max: 16

Schedule Schedule Details

Class Schedule for Spring Semester 2022

	Sunday	Monday	Tuesday	Wednesday	Thursday	Friday	Saturday
6am							
7am							
8am							
9am							
10am							

Panels ▾

Submit

2 pages

 Save as PDF

All

Portrait

1

Cancel

Records: 5

Saturday

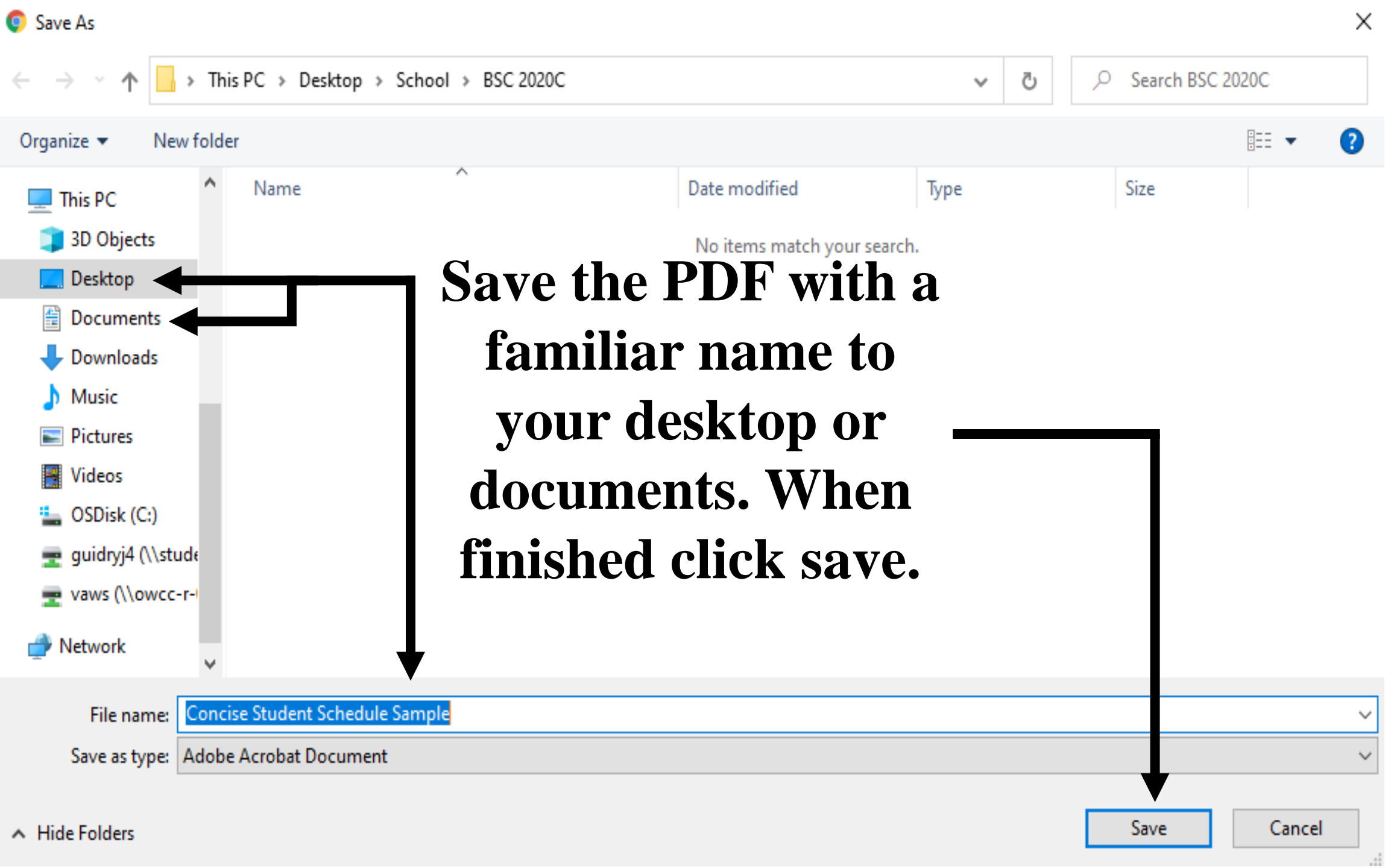

☐ No

VA Education Benefit listed on your Certificate of Eligibility *

- ☐ MGIB (Ch 30)
- ☐ Veterans Readiness & Employment (Ch 31)
- ☐ Post 9/11 (Ch 33)
- ☐ Dependent Education Assistance (Ch 35)
- ☐ Reservist (Ch 1606)
- ☐ Other:

Effective Term of Request (only terms from menu are accepted at this time) *

Spring (January through May)



Type of VA certification request submitting: New or Updating? *

New enrollment certification request for the term listed above.



Please list any course(s) NOT required for graduation that are listed on your Concise Student Schedule which cannot be certified for VA education benefits [alternate funding source will be used to pay for class(es)]. Enter NONE if not applicable. *

applicable?.

Enter Degree Program Studying *

Example: Associate in Arts or Associate in Science Nursing

A current signed program of study is required for your VA file. Has your degree program changed since your last VA certification?

Navigate back to VA Certification Request Form and select choose file. Locate where you saved your concise student schedule and upload.

Year *

Concise Student Schedule Upload *

Choose File



Contact the Veterans Success Center at 850-502-2895, option 3 if you require assistance on how to locate and upload your Concise Student Schedule in RaiderNet.